

# ROBUSTA CANDLE SET

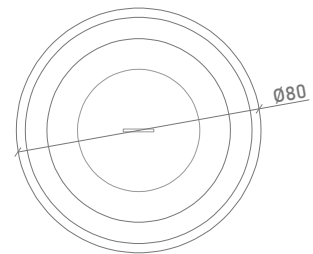

# ROBUSTA CANDLE SET

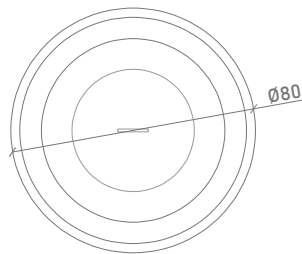
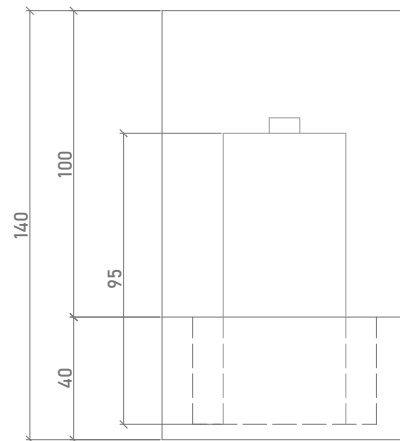
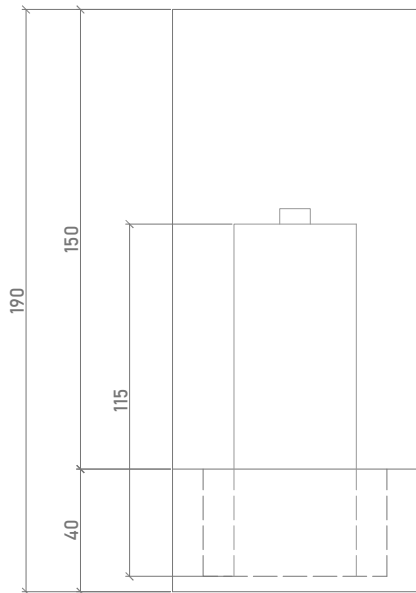

## MATERIAL

Oak or walnut wood, blown smoked grey glass, soy wax and wooden wick candle

## DIMENSIONS

S: Ø 80 x 135 mm

M: Ø 80 x 185 mm

-All parts of this piece are completely independent

This is a completely handmade piece. For this reason, below we leave you a complete guide on how you can take care of this piece to make sure it will last.

### **Blown Glass:**

#### **Cleaning**

- Use care when handling the piece
- Make sure your hands are clean
- Pick up by the base
- Loosen the dust with a lint-free microfiber cloth

#### **Water & Detergents**

- Use a damp lint-free cloth to wipe glass art after dry dusting
- Wash gently in warm water with neutral soap
- Do not use ammonia, cream cleaners or any harsh chemicals to clean

#### **Drying**

- After washing dry your piece thoroughly with a soft cloth

**Do not** wash two pieces together as they may get scratched or damaged in the process

**Do not** put extremely hot or cold liquid into your glass as this may cause it to crack

**Do not** put your piece in a dishwasher

**Do not** use aerosol cleaners

### **IMPORTANT NOTE !**

**Air bubbles are a natural characteristic of handmade glass**, reflecting the dynamic smelting process that ceases once the piece is formed, leaving the bubble as a timeless imprint. Each bubble is a testament to the uniqueness and originality of the craft, carrying a trace of the glassmaker's artistry and spirit.

A small bubble is not considered a defect and **does not warrant a return**. However, we prioritize customer satisfaction, so if you are unhappy with your item, our team will be happy to assist with an exchange or find another solution.